

Spanish Property South Africa



Costa Blanca & Costa Calida Properties

email: info@spanishproperty.co.za

web: www.spanishproperty.co.za

V-87340

Apartment in Santa Pola

420,000 €



Year Built:	--
Build Size:	154m²
Plot Size:	
Bedrooms:	2
Bathrooms:	2
Pool:	No
Air conditioning:	--
Central heating:	--
Parking:	--
Terrace:	--
Location:	Santa Pola
Property Type:	Apartment

NEW BUILD RESIDENTIAL COMPLEX IN SANTA POLA Modern gated residential complex comprising 3 blocks of apartmwns with large landscaped communal areas including a swimming pool with water beds, children's playground, pergola and bicycle parking. The residential has 3 and 2 bedrooms apartments, both types include 2 full bathrooms, open plan kitchen with living room, fitted wardrobes, terrace, parking space. They have a common garden , swimming pool with beach-type entrance, equipped with showers and a large wooden pergola. It has landscaped areas with palm trees and vegetation, all of which are illuminated. In the central part of the pool there is a shallower area where the water beds are located. The municipality of Santa Pola is located on the popular Costa Blanca on the Mediterranean, south of Alicante and in the Bajo VinalopÃ³ region. The city is in an enviable geographical position, surrounded by natural landscapes and with a special microclimate, which offers a mild climate all year round. Its urban center is bounded by the Castle Fortress and the port to the east and west, and is bordered by the Santa Pola Salinas Natural Park and the Sierra and Cabo de Santa Pola, an ancient reef today characterized by its reef leafy pine trees. Santa Pola located 21 km. ...

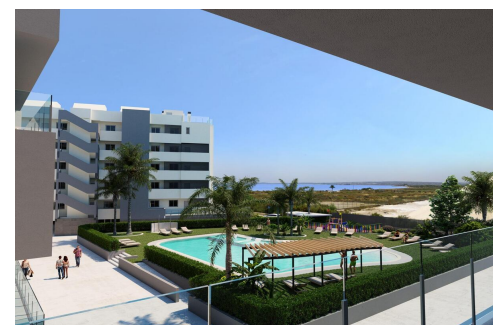

PLANTA 2da VIVIENDAS 2, 3 y 4		
SUPERFICIES ÚTILES	SUPERFICIES CONSTRUIDAS	
Vivienda 2	84,00 m²	84,00 m²
Vivienda 3	84,00 m²	84,00 m²
Vivienda 4	84,00 m²	84,00 m²
TOTAL	252,00 m²	252,00 m²



PLANTA Cubierta VIVIENDAS 2, 3 y 4 Terraza		
SUPERFICIES ÚTILES	SUPERFICIES CONSTRUIDAS	
Vivienda 2	84,00 m²	84,00 m²
Vivienda 3	84,00 m²	84,00 m²
Vivienda 4	84,00 m²	84,00 m²
TOTAL	252,00 m²	252,00 m²

